

JHF25M-5MP SWIR

【SPECIFICATIONS】 Applicable Fixed Lens to InGaAs Camera(900~1700nm)

Image Size: 2/3

Focal Length : 25mm
 Maximum Relative Aperture : 1:1.4
 Iris : F1.4~22
 Angle of View : 20.0×15.0°
 Image Size : 8.8×6.6mm (φ11mm)
 Minimum Object Distance : 0.2m (From Front Vertex)
 Resolution : Equivalent to VGA at 900~1700
 Optics Distortion : Max-0.07% (at near)
 0.21% (at far)
 TV Distortion : 0.02% (at near)
 0.11% (at far)

Optical Back Focal Distance : 14.01mm(In Air)
 Flange Back : 17.526mm
 Operation : Focus : Manual
 Iris : Manual
 Operating Temperature : -10~+50°C
 Mount : C-Mount (Adjustable Lens Position)
 Filter Size : 49mm P0.75
 Size : φ51×48mm
 Weight : Approx.190 g

【COMPOSITION】

- Lens 1
- Lens Cap 1
- Dust Cap 1

【DIMENSIONS】

Wave(μm)	Flange Back(mm)
0.9	17.667
1.1	17.891
1.3	18.200
1.5	18.598
1.7	19.097

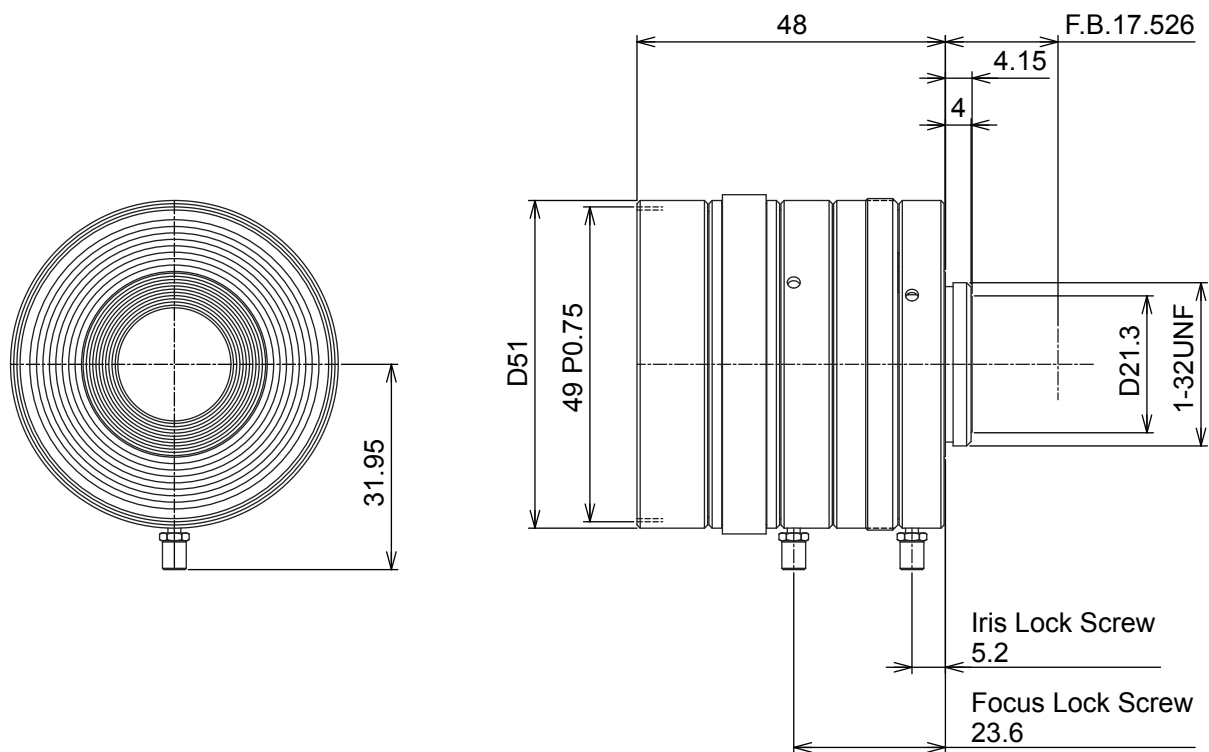

Unit:mm